

Scatter Tube

Instructions for use

TRIBUTES
for memories to cherish



1 Remove outer lid and separate the inner & outer tube.



2 Place the inner tube firmly in a flat surface & slowly fill with cremains, using a funnel if necessary.



3 Run a generous line of glue around the inside of the outer tube about 2.5cm or 1 inch from the top edge.



4 Line up the openings of both tubes & push outer tube slowly downwards to allow air to gently escape through the vent hole.

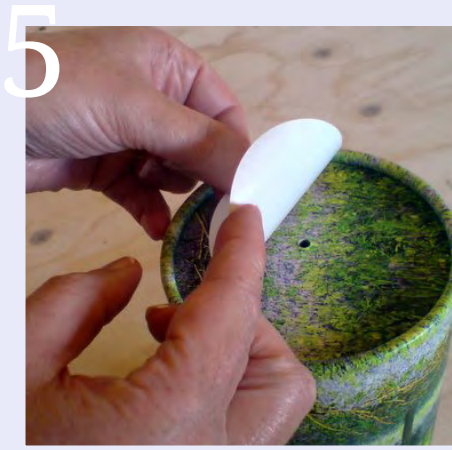

5 Once the tubes are firmly in place, attach the sticker provided over the vent hole before returning the tube to its upright position.



6 Turn the sealed tube over and place the outer lid on, ensuring that any pattern is neatly aligned

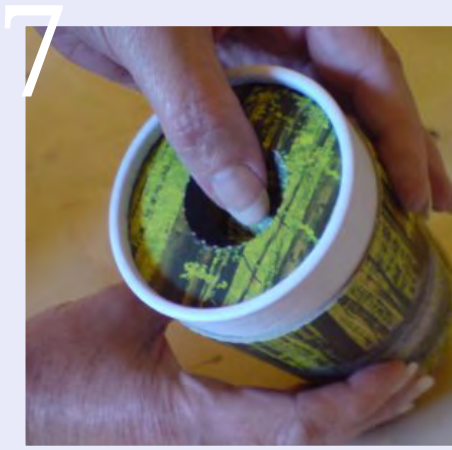

7 To scatter the ashes, remove the outer lid and push out the perforated disc.



Keepsake Size

PLEASE NOTE:
The keepsake (4in³) size does not have an inner lid and perforation. Simply remove the lid and discard the silica gel pack before filling or scattering ashes.